

SIKA TILING SYSTEM FOR LARGE-SIZE TILES

The laying of large format ceramic and natural stone tiles requires special solutions that Sika provides: a flat surface is achieved with levelling technology designed to avoid separation and imperfections, together with an excellent finish. This is a new generation, high performance, highly flexible, cementitious adhesive, with a high polymer content that is applied in two layers.

Then a flexible tile grout with low modulus, and excellent mechanical strength and abrasion resistance is used, together with a high performance elastic polyurethane based sealant for moving joints and connections.

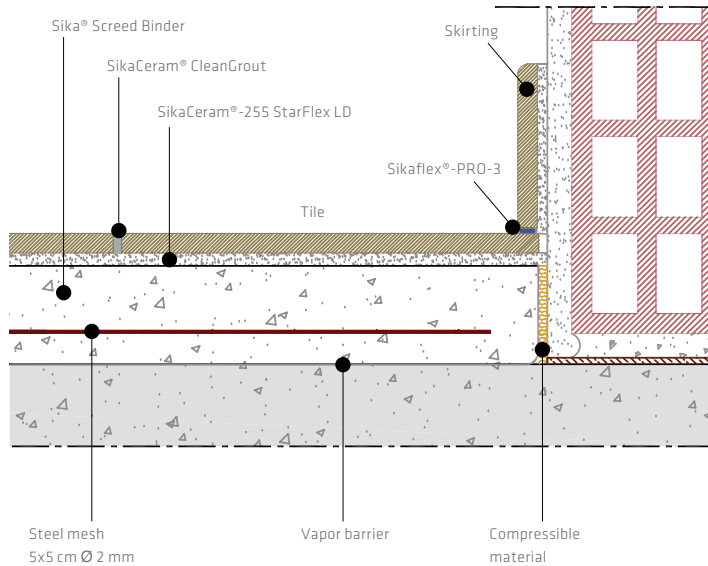

KNOW-HOW FROM SITE TO SHELF



TILING SYSTEM FOR LARGE-SIZE TILES



Your Local Sika Partner:

Our most current General Sales Conditions shall apply. Please consult the most current local Product Data Sheet prior to any use.

SIKA SERVICES AG

Refurbishment
 CH-8048 Zurich
 Switzerland
 Phone +41 58 436 40 40
 Fax +41 58 436 46 86
www.sika.com

© Sika Services AG / Refurbishment / CMOI / Tiling System For Large-Size Tiles / 09.2014 / B47 / ID43030



BUILDING TRUST



SIKA TILING SYSTEM FOR LARGE-SIZE TILES

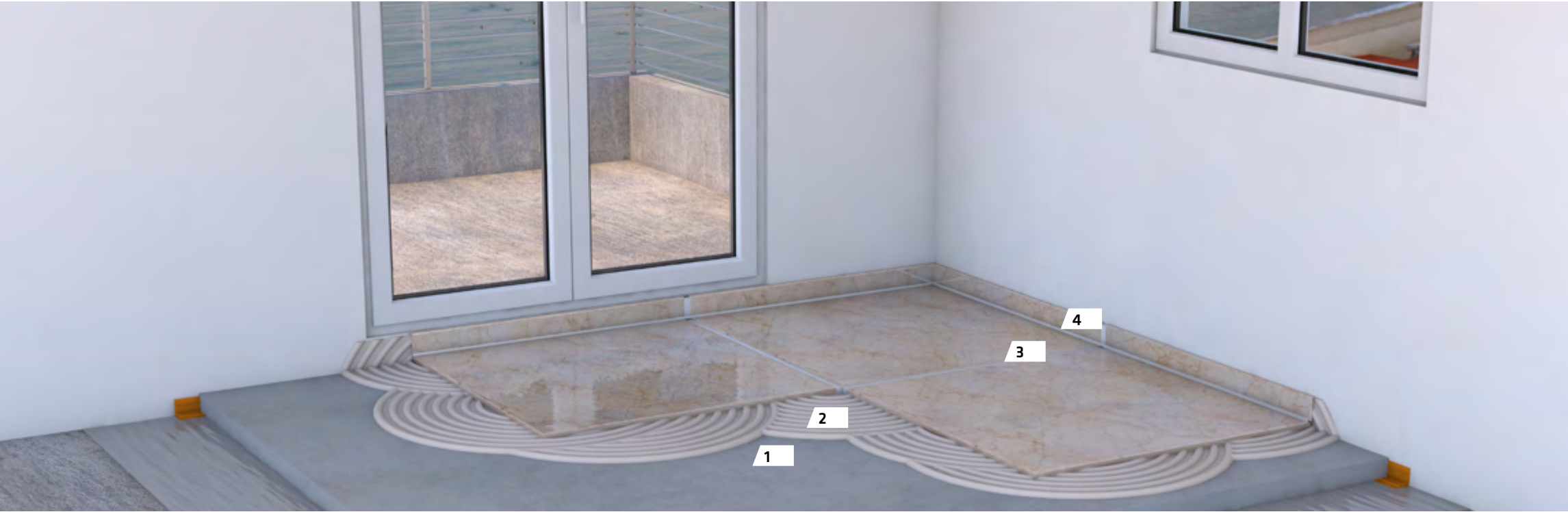

SURFACE PREPARATION

1



Sika Screed® Binder

Hydraulic binder for screeds (4 - 10 cm) with normal setting, quick-drying and low shrinkage, for internal and external use. Needs to be mixed with aggregates.

TILE ADHESIVE

2



SikaCeram®-255 StarFlex LD

Highly deformable tile adhesive, for laying large sized ceramic tiles, with low dust emissions. C2TE S1.

TILE GROUT

3



SikaCeram® CleanGrout

Cementitious tile grout for 1 - 8 mm width. Water repellent, anti-fungus, high abrasion resistance, with very stable colors. CG2. It can be mixed with: SikaCeram® T-Latex S1.

SEALANT

4



Sikaflex®-PRO-3

Elastic, one-part, high performance polyurethane based sealant, for use in horizontal and vertical joints subject to movement and exposure to water and many different chemical, both internally and externally.